

# Silensor-sl

Verbinderwechsel • exchange of a connector • changement d'attache  
cambio de conector • sostituzione congiuntore • substituição do conector

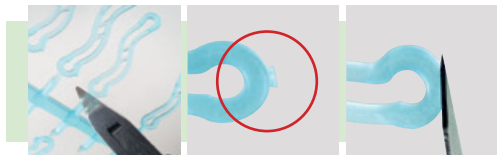

- loser Anker
- loose anchor
- ancre lâche
- ancla suelta
- ancorraggio staccato
- soltar suporte

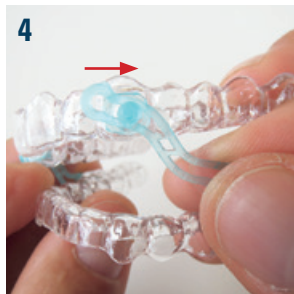
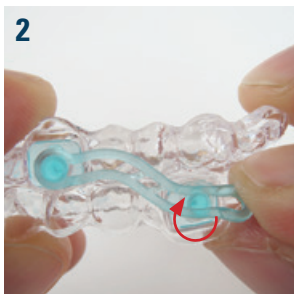

- Anker halten
- hold anchor
- tenir ancre
- mantener ancla
- tenere premuto l'ancoraggio
- segurar suporte



restliche Verbinder hier aufkleben  
 glue remaining connectors here  
 coller attaches restantes ici  
 pegar conectores restantes aquí  
 colla premuto l'ancoraggio qui  
 colar aqui os restantes conectores

zuerst verwendeter Verbinder  
 first used connector  
 attache en premier utilisée  
 conector utilizó por primera vez  
 congiuntore prima utilizzazione  
 conector a utilizar na primeira vez

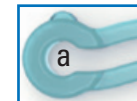
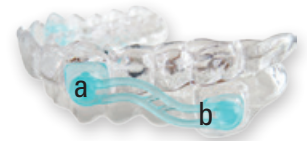
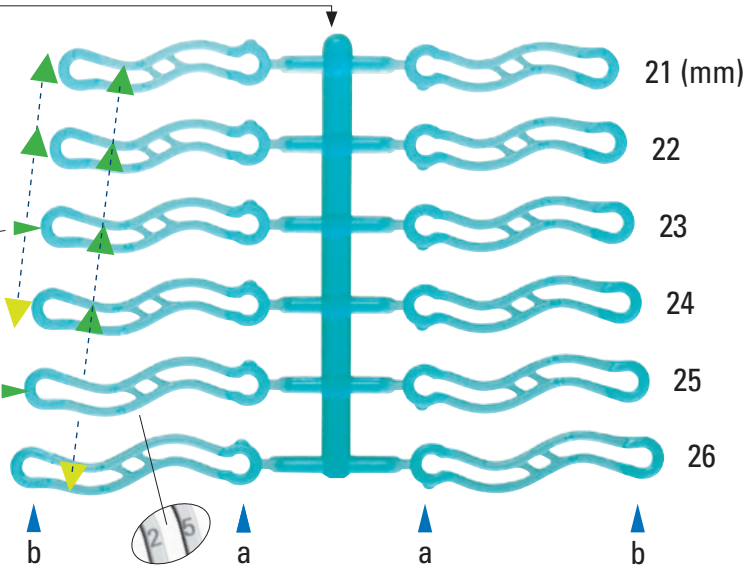

oberer Eckzahn  
 upper canine  
 canine supérieure  
 canino superior  
 canino superiore  
 canino superior



unterer Molarenbereich  
 lower molar area  
 région molaire inférieure  
 zona de molares inferior  
 zona dei molari inferiori  
 zona do molar inferior

